

Product Code	Description
JC841PC-W	1 Gang RJ45 Cat. 6A Data Socket Outlet

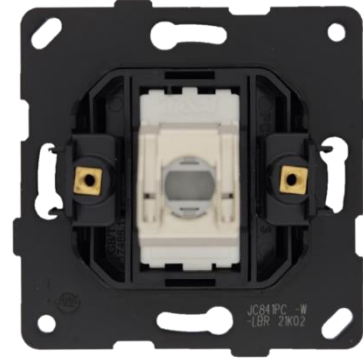

JC841PC-W-LBR



Product back view

(with CAT 6A jack)

Technical Specification

- With shutter dust cover
- Punch down termination
- Compatible CAT6_A jack:
RJD-6AS8880-20D
(Full Shielded, 180° die-cast tool-less IDC jack, Metal)
-support both T568A & T568B wiring
- Fix Centre: 60.3 mm
- Fix Screw: M3.5 x 0.6 x 25mm±

With Lavina '95 Frame: JC1401

- Dimensions: 95x95x10mm (WxHxD)
- Mounting box: >35mm depth*
*Allow room for bend radius of cable
 - J1040, flush mounting, plastic
74.5 x 74.5 x 42mm (W x H x D)
 - M1050, flush mounting, metal
75.5 x 64 x 50mm (W x H x D)

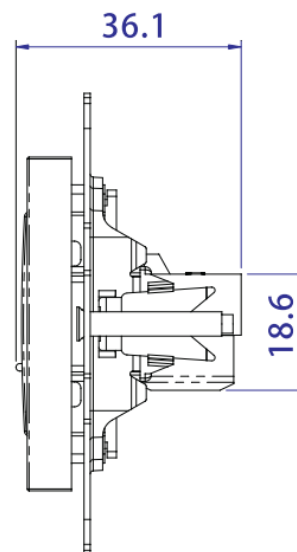
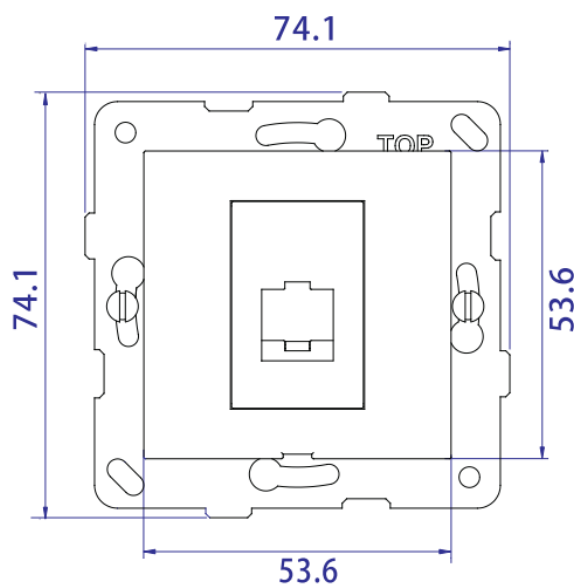

Product side view

(with CAT 6A jack)

Product dimensions (mm)

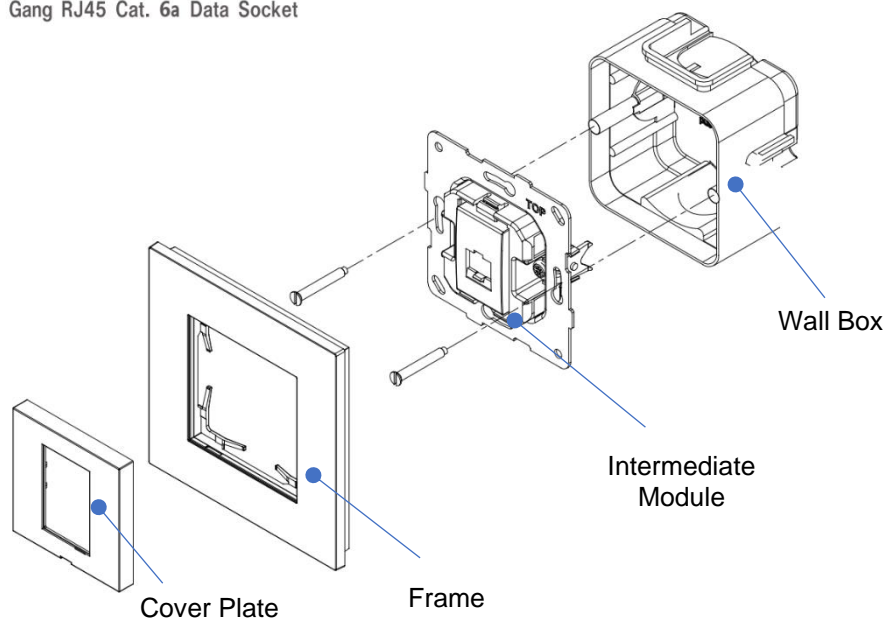

Single-gang Assembly

1 Gang RJ45 Cat. 6a Data Socket

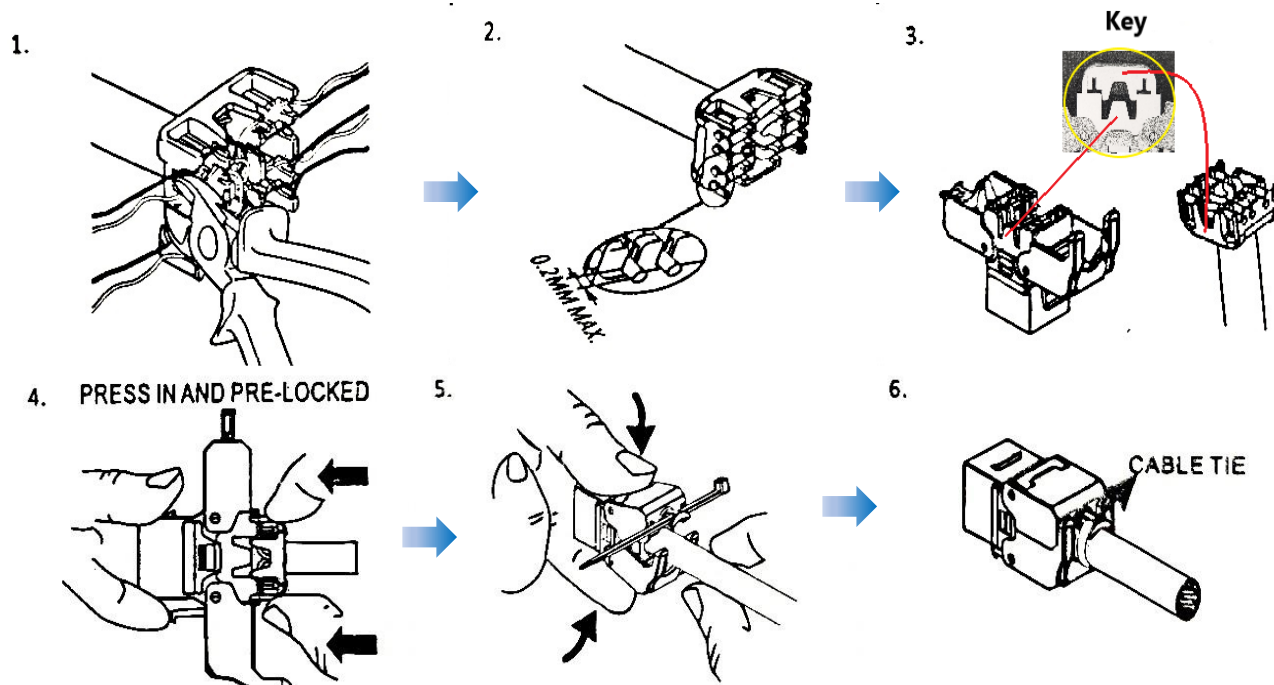

Typical Wiring Guide (CAT 6A Jack, for reference)



Product Code	Colour
JC841PC -W-LWH	 Matt White
JC841PC-W-LBL	 Matt Black
For other colours, please contact T&J Sales representative	